



**Killeshal Precast Concrete Ltd**  
 Daingean, Co. Offaly, Ireland  
 Tel: +353 57 953018  
 Fax: +353 57 9353272  
 Email: sales@killeshal.com  
 Web: www.killeshal.com

**74.018**

**ZTL Table**

Doc Ref: Kilform 286/04/08

Rev Lvl 7

Drawn By NM 27/10/2015

Approved By

Approx Weight 141 Kgs

PN 19/06/14

Note: In Concrete Products, all Vertical Faces would typically have a taper of 4mm in every 100mm.

All dimensions as per drawing and allowable tolerances

Bolts as per specification and drawing

Quantity as per order

Welding Visually Correct

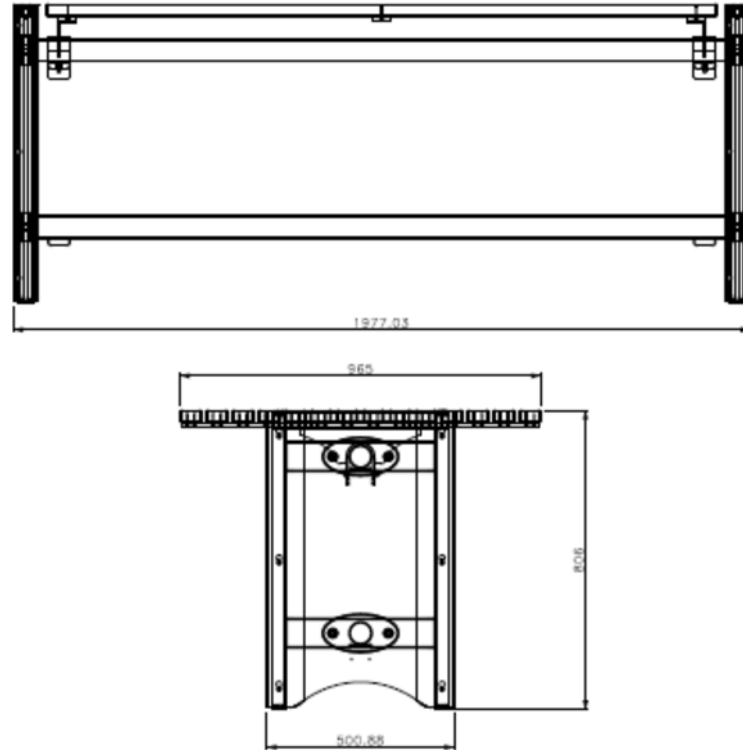

© All Rights Reserved D.E.S.T.B.M.

Manufacturer's Reference 20 1600

Max Units per Pallet 4 no.

Scale N.T.S.

